

APPLICATION TO INSTALL PRIVATE LINE

DATE: 8/14/17

TO THE COMMISSIONERS COURT OF BROWN COUNTY,

Application is hereby made by COLEMAN COUNTY TEL, to install a buried or aerial water
telephone electric gas line within the right-of-way and/or across a county road in Brown County,
Texas, as follows:

Precinct # 42 Location: CORD 411 This will involve a bore or cut .

The location and description of the proposed line and associated appurtenances is more fully shown by the plat of such line attached to this application. The line will be constructed and maintained on the County right-of-way in accordance with governing laws. And installed at a depth of 24" to 30" below the lowest level of the bar ditch.

The applicant agrees to remove or relocate such fixtures at his own expense so as to permit the widening or changing of traffic lanes or reconstruction of the roadbed. Such removal or relocation shall be within 30 days of written notice specifying the fixtures to be moved and indicate the place on the roadway to which they shall be replaced.

Notwithstanding any other provision contained herein, it is expressly understood that tender of this notice by the undersigned does constitute a waiver, surrender, abandonment or impairment of any property rights, franchise, easement, license, authority, permission, privilege or right now granted by law or may be granted in the future and any provision of provisions so construed shall be null and void.

The Commissioner of the above precinct will be notified of the time and date of installation at least 24 hours in advance.

This permit will become null and void if work is not completed within 90 days from date of acceptance by the Brown County Commissioners Court.

I certify that the above-proposed installation will not impair or harm the ingress and egress of adjacent landowners.

Construction of this line will begin on or after the 28 day of AUGUST, 2017

By DANNY COOK
Address 215 N 2ND ST
SANTA ANNA, TX
Phone 325-348-7524

August 21, 2017
(Exhibit #6)

This staking sheet is intended and prepared for route designation only and the Engineer hereby and as expressly set out in the contract, disclaims any and all responsibility and / or obligation for marking, noting and / or reflecting the existence and / or location of any and all underground facilities, including but not limited to petroleum bearing pipelines, not withstanding said facilities may be visible and / or marked on the surface along, over or across said proposed route as shown on this staking sheet.

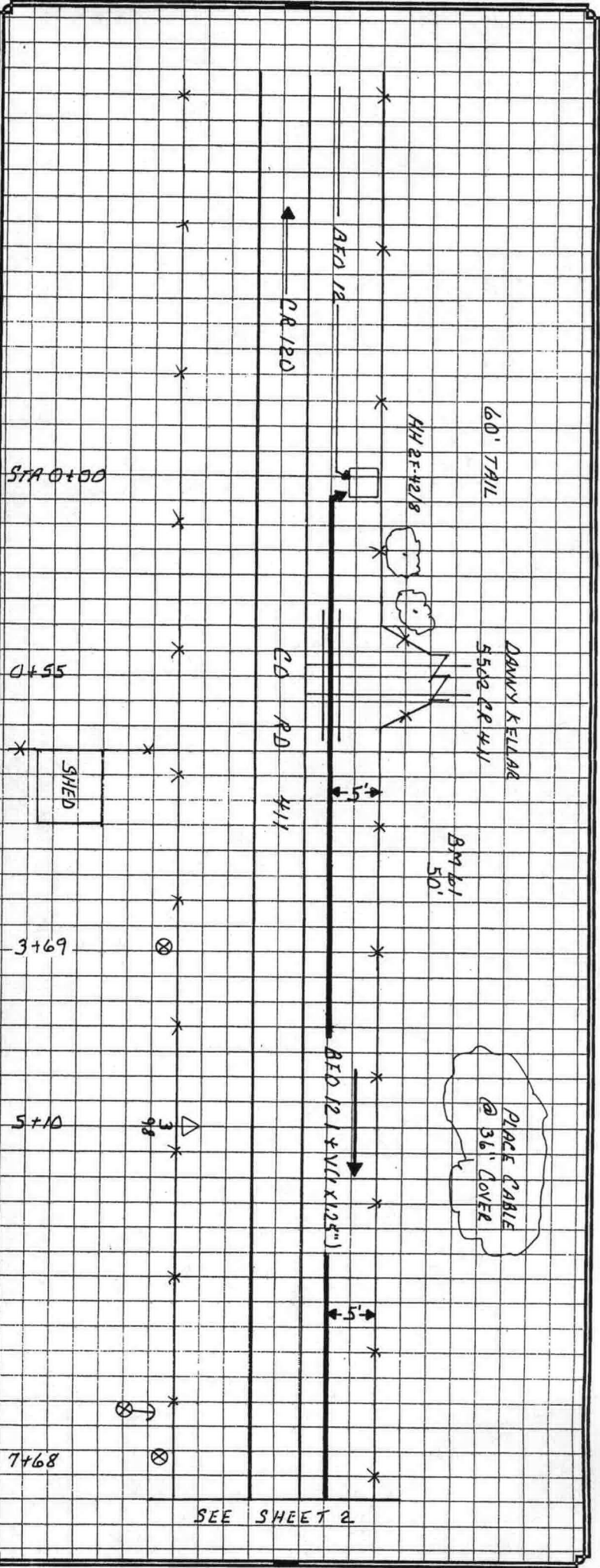

HH / PED #	BM	DESCRIPTION	SUB. NO.
HH 8	(60)	BFO 12	
	(1)	BM 53F	
	(50)	BM 611	
	(1)	HBFO 5	
	(1)	HO-1	

CCTC

NAME: DAVID GRAY
 WO: 2347
 ECH: BURNETT
 ROUTE: 2E-42
 ROW: COUNTY
 STATE: TX
 COUNTY: BROWN

System Designation: _____
 Tax District: _____
 Map Number: _____
 Staked By: LS Date: 8-7-17
 Cont. Met By: _____
 Drawing Not to Scale
 Sheet 1 of _____ Page # _____

SEE SHEET 2

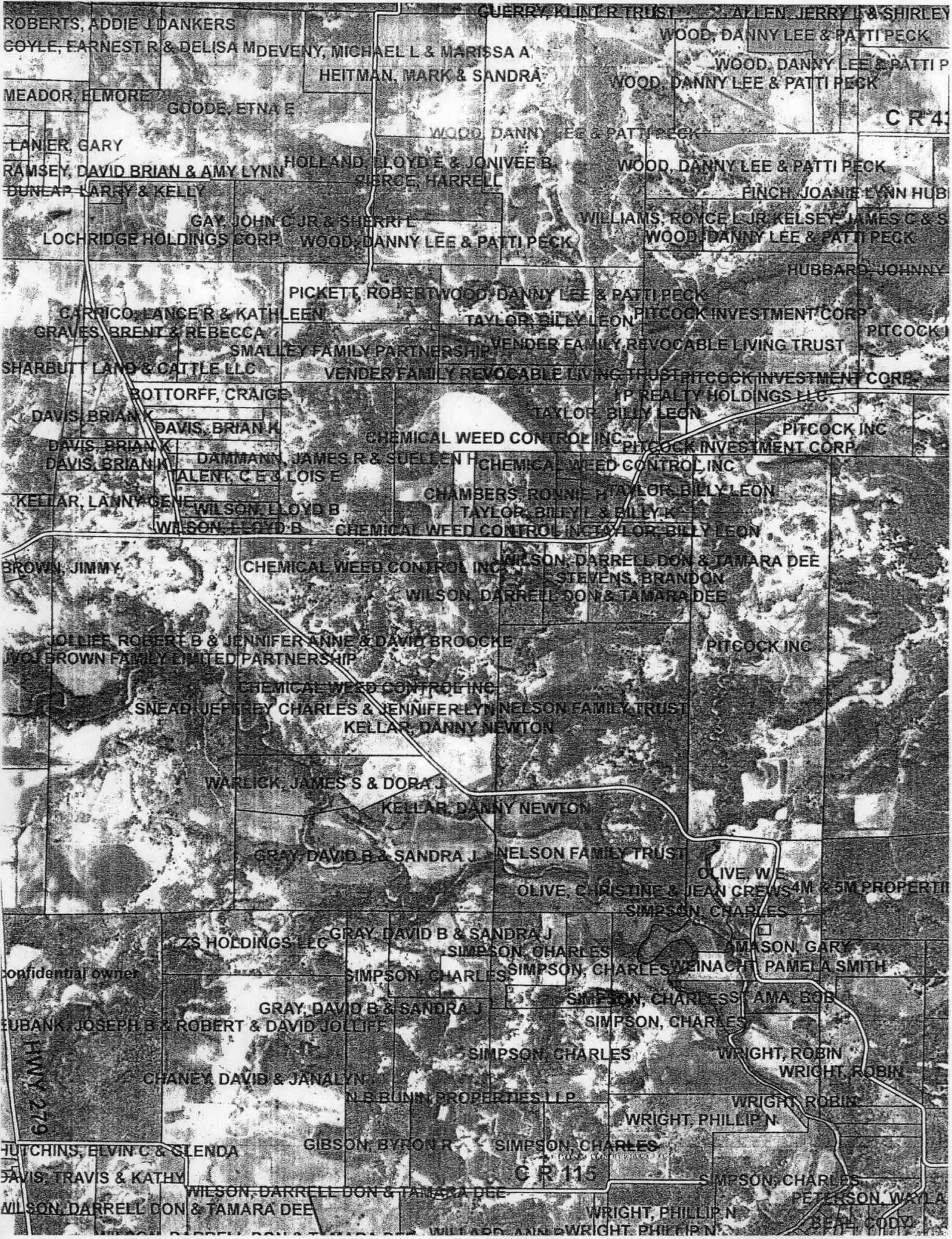

ROBERTS, ADDIE J DANKERS
GOYLE, EARNEST R & DELISA M DEVENY

HEITMAN, MARK & SANDRA

GUERRY, KLINT R TRUST
ALLEN, JERRY L & SHIRLEY
WOOD, DANNY LEE & PATTI PECK

MEADOR, ELMORE
GODDE, ETNA E

HOLLAND, LLOYD E & JONIVEE B
PIERCE, HARRELL

WOOD, DANNY LEE & PATTI PECK

LANIER, GARY
RAMSEY, DAVID BRIAN & AMY LYNN

WOOD, DANNY LEE & PATTI PECK

WOOD, DANNY LEE & PATTI PECK

DUNLAP, LARRY & KELLY
LOCHRIDGE HOLDINGS CORP

WOOD, DANNY LEE & PATTI PECK

WOOD, DANNY LEE & PATTI PECK
FINCH, JOANIE LYNN HUB

GAY, JOHN C JR & SHERRIL
WOOD, DANNY LEE & PATTI PECK

WOOD, DANNY LEE & PATTI PECK

WILLIAMS, ROYCE L JR KELSEY, JAMES C & S
WOOD, DANNY LEE & PATTI PECK

GARRICO, LANCE R & KATHLEEN
GRAVES, BRENT & REBECCA

PICKETT, ROBERT WOOD, DANNY LEE & PATTI PECK
TAYLOR, BILLY LEON

HUBBARD, JOHNNY
PITCOCK INVESTMENT CORP
PITCOCK I

SHARBUTT LAND & CATTLE LLC
BOTTORFF, CRAIG E

SMALLEY FAMILY PARTNERSHIP
VENDER FAMILY REVOCABLE LIVING TRUST

PITCOCK INVESTMENT CORP
PITCOCK I

DAVIS, BRIAN K
DAVIS, BRIAN H

CHEMICAL WEED CONTROL INC
TAYLOR, BILLY LEON

PITCOCK INVESTMENT CORP
PITCOCK I

DAVIS, BRIAN K
DAVIS, BRIAN H

DAMMANN, JAMES R & SUELEEN H
VALENT, C E & LOIS E

CHEMICAL WEED CONTROL INC
TAYLOR, BILLY LEON

KELLAR, LANNY GENE
WILSON, LLOYD B

WILSON, LLOYD B
CHEMICAL WEED CONTROL INC

TAYLOR, BILLY LEON
TAYLOR, BILLY L & BILLY K
TAYLOR, BILLY LEON

BROWN, JIMMY
JOLLIFFE, ROBERT B & JENNIFER ANNE & DAVID BROOKE

CHEMICAL WEED CONTROL INC
WILSON, DARRELL DON & TAMARA DEE

WILSON, DARRELL DON & TAMARA DEE
STEVENS, BRANDON
WILSON, DARRELL DON & TAMARA DEE

WOL BROWN FAMILY LIMITED PARTNERSHIP
SNEAD, JEFFREY CHARLES & JENNIFER LYNN NELSON FAMILY TRUST

KELLAR, DANNY NEWTON
WARLICK, JAMES S & DORA J

PITCOCK INC
PITCOCK INC

WARLICK, JAMES S & DORA J
KELLAR, DANNY NEWTON

GRAY, DAVID B & SANDRA J
NELSON FAMILY TRUST

PITCOCK INC
PITCOCK INC

ZS HOLDINGS LLC
GRAY, DAVID B & SANDRA J

SIMPSON, CHARLES
SIMPSON, CHARLES

OLIVE, W E
SIMPSON, CHARLES
OLIVE, CHRISTINE & JEAN CREWS 4M & 5M PROPERTIES

CONFIDENTIAL OWNER
EUBANK, JOSEPH B & ROBERT & DAVID JOLLIFFE

GRAY, DAVID B & SANDRA J
SIMPSON, CHARLES

MASON, GARY
WEINACHT, PAMELA SMITH
SIMPSON, CHARLES
SIMPSON, CHARLES

CHANNEY, DAVID & JANALYN
GIBSON, BYRON R

SIMPSON, CHARLES
SIMPSON, CHARLES

WRIGHT, ROBIN
WRIGHT, ROBIN
WRIGHT, PHILLIP N

HUTCHINS, ELVIN C & GLENDA
DAVIS, TRAVIS & KATHY

WILSON, DARRELL DON & TAMARA DEE
WILSON, DARRELL DON & TAMARA DEE

WRIGHT, PHILLIP N
SIMPSON, CHARLES
PETERSON, WYLA
BEAT, CODY

WILSON, DARRELL DON & TAMARA DEE
WILSON, DARRELL DON & TAMARA DEE

GIBSON, BYRON R
SIMPSON, CHARLES

WRIGHT, PHILLIP N
SIMPSON, CHARLES
PETERSON, WYLA
BEAT, CODY

WILSON, DARRELL DON & TAMARA DEE
WILSON, DARRELL DON & TAMARA DEE

GIBSON, BYRON R
SIMPSON, CHARLES

WRIGHT, PHILLIP N
SIMPSON, CHARLES
PETERSON, WYLA
BEAT, CODY

WILSON, DARRELL DON & TAMARA DEE
WILSON, DARRELL DON & TAMARA DEE

GIBSON, BYRON R
SIMPSON, CHARLES

WRIGHT, PHILLIP N
SIMPSON, CHARLES
PETERSON, WYLA
BEAT, CODY

WILSON, DARRELL DON & TAMARA DEE
WILSON, DARRELL DON & TAMARA DEE

GIBSON, BYRON R
SIMPSON, CHARLES

WRIGHT, PHILLIP N
SIMPSON, CHARLES
PETERSON, WYLA
BEAT, CODY

WILSON, DARRELL DON & TAMARA DEE
WILSON, DARRELL DON & TAMARA DEE

GIBSON, BYRON R
SIMPSON, CHARLES

WRIGHT, PHILLIP N
SIMPSON, CHARLES
PETERSON, WYLA
BEAT, CODY

WILSON, DARRELL DON & TAMARA DEE
WILSON, DARRELL DON & TAMARA DEE

GIBSON, BYRON R
SIMPSON, CHARLES

WRIGHT, PHILLIP N
SIMPSON, CHARLES
PETERSON, WYLA
BEAT, CODY

WILSON, DARRELL DON & TAMARA DEE
WILSON, DARRELL DON & TAMARA DEE

GIBSON, BYRON R
SIMPSON, CHARLES

WRIGHT, PHILLIP N
SIMPSON, CHARLES
PETERSON, WYLA
BEAT, CODY

WILSON, DARRELL DON & TAMARA DEE
WILSON, DARRELL DON & TAMARA DEE

GIBSON, BYRON R
SIMPSON, CHARLES

WRIGHT, PHILLIP N
SIMPSON, CHARLES
PETERSON, WYLA
BEAT, CODY

WILSON, DARRELL DON & TAMARA DEE
WILSON, DARRELL DON & TAMARA DEE

GIBSON, BYRON R
SIMPSON, CHARLES

WRIGHT, PHILLIP N
SIMPSON, CHARLES
PETERSON, WYLA
BEAT, CODY

WILSON, DARRELL DON & TAMARA DEE
WILSON, DARRELL DON & TAMARA DEE

GIBSON, BYRON R
SIMPSON, CHARLES

WRIGHT, PHILLIP N
SIMPSON, CHARLES
PETERSON, WYLA
BEAT, CODY

WILSON, DARRELL DON & TAMARA DEE
WILSON, DARRELL DON & TAMARA DEE

GIBSON, BYRON R
SIMPSON, CHARLES

WRIGHT, PHILLIP N
SIMPSON, CHARLES
PETERSON, WYLA
BEAT, CODY

CR 41

CR 115

HWY 279

APPROVAL:

Coleman County Telephone
Danny Cook
215 N. 2nd St
Santa Anna, TX.

The Commissioner's Court of Brown County offers no objections to the location on the right-of-way and/or crossing of your proposed buried line as shown by accompanying drawings and notice dated 8/14/17, except as noted below:

It is further intended that the Commissioner's Court may require the owner to relocate This line, subject to provisions of governing laws, by giving thirty (30) days written notice.

The installation shall not damage any part of the county road and adequate provisions must be made to cause a minimum inconvenience to traffic and adjacent property owners.

Please notify Joel Kelton, Commissioner of Precinct # 2,

Twenty-four (24) hours prior to starting construction of the line, in order that we may have a representative present.

BROWN COUNTY COMMISSIONERS COURT
OF BROWNWOOD, TEXAS

BY: E Ray Westra

Exceptions and/or special requirements: To be constructed according to Brown County specifications

In ditch & road bore specs.